

Howden Recreation Centre

**Accessibility
Advisory
Committee
Presentation**

December 10, 2024



Howden Recreation Centre

Queen St & Central Park Dr

Location

Located at 150 Howden Blvd at the location of the former Howden Rec Centre

Building Program

- Multisport Court
- Multipurpose Rooms (3)
- Event Rooms (2)
- Community Room and Lounge
- Group Fitness
- YMCA Child Care (3rd Party Tenant)

Site Program

- Outdoor Multisport Court
- Seating and gathering spaces
- Outdoor Multipurpose space

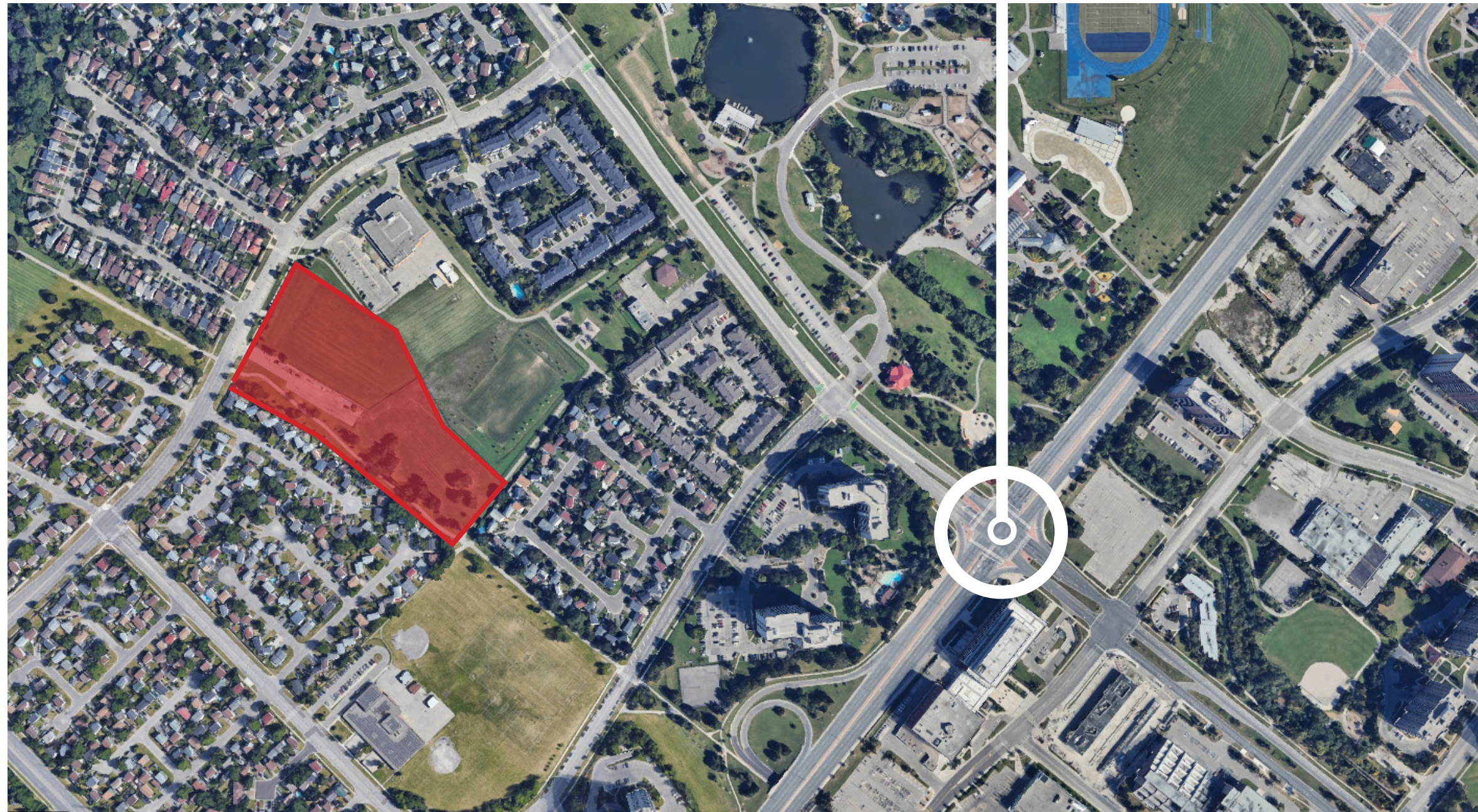

- Connection to Brampton trail system

Site Organization

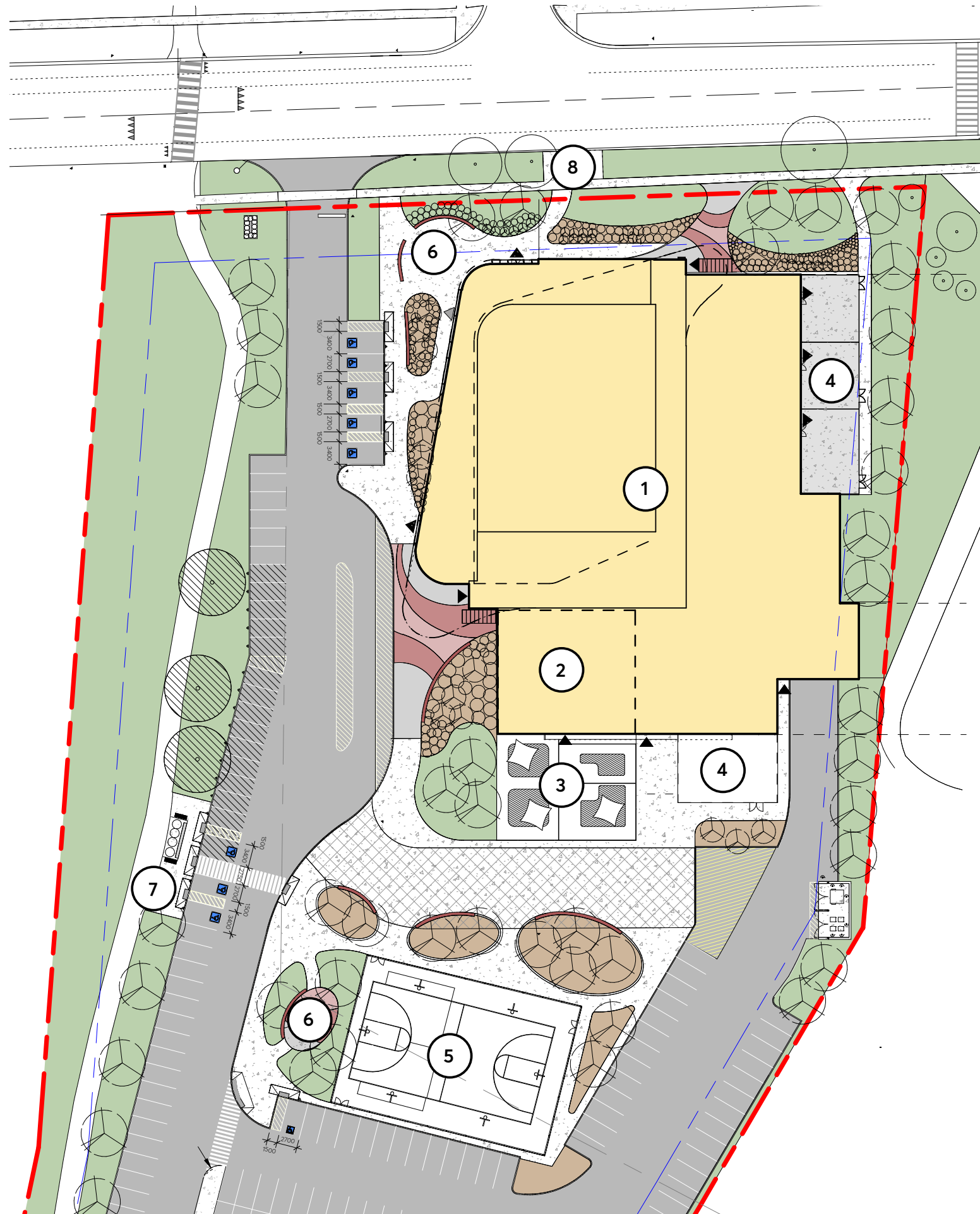
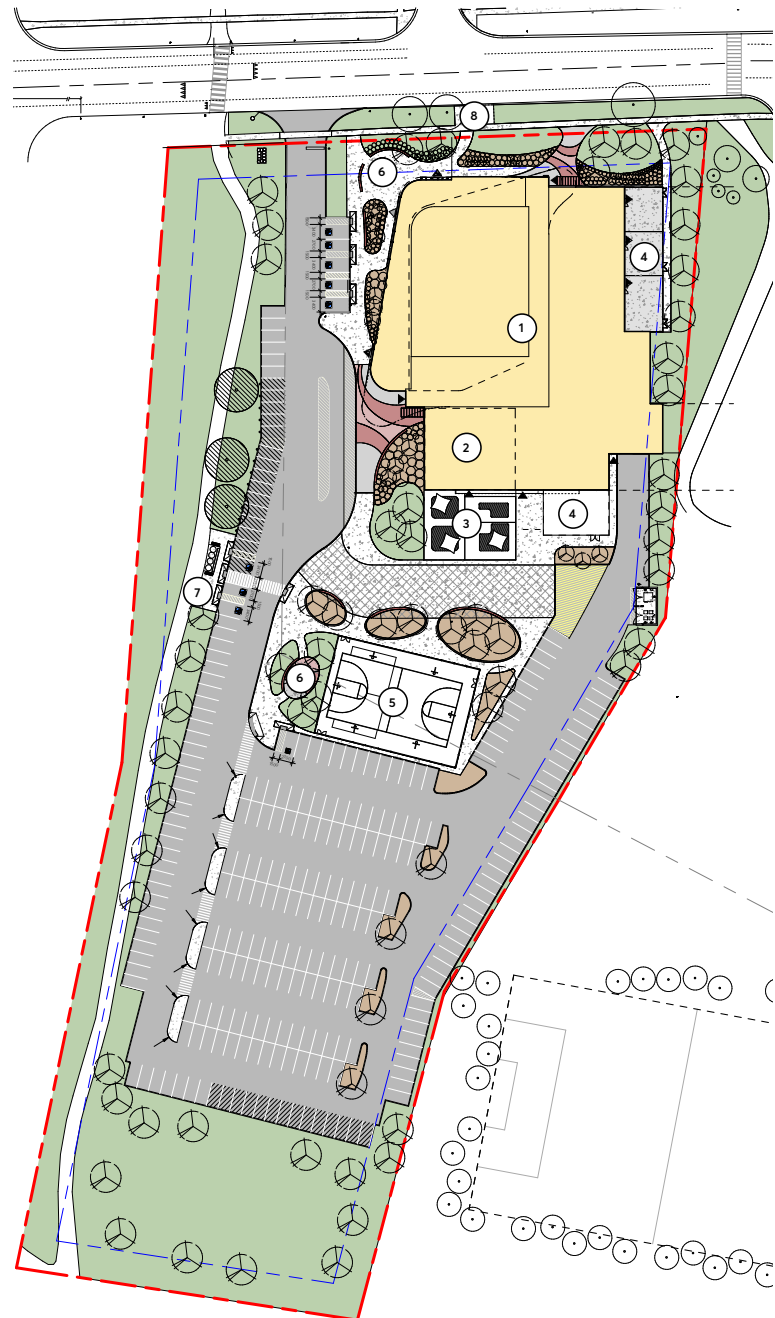

Site Program Legend

- 1** - Proposed Recreation Centre
- 2** - Proposed Tenant Daycare Space (Not City Operated)
- 3** - Tenant Outdoor Play Space (Not City Operated)
- 4** - Outdoor Space Connected to Interior Programs
- 5** - Outdoor Multisport Court
- 6** - Pedestrian Rest/ Seating Areas
- 7** - Connection to City Trail System
- 8** - Bus Pad (Public Transit)

Site Circulation

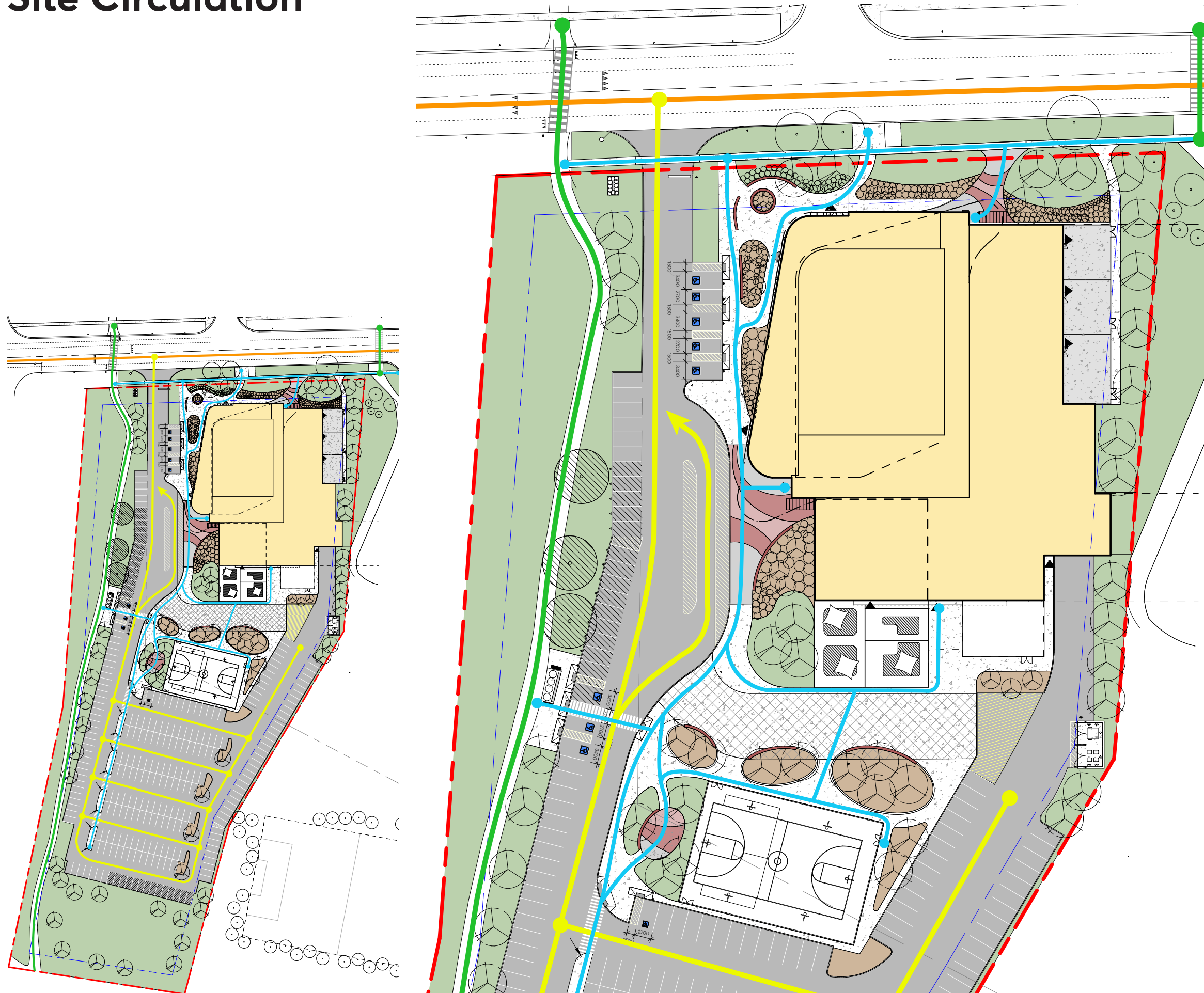

Site Circulation Legend

- Howden Blvd Street Circulation
- Site Vehicular Circulation
- Site Pedestrian Circulation Accessible
- External Pedestrian Connections

Facility Interior

Finishes

- High contrast finishes
- Easily cleanable wipable finishes
- Non-slip even surfaces throughout
- Minimize transitions between flooring types to ensure minimal impediments
- Colour coding used as a supplement to wayfinding.

Visibility

- High level of visibility between spaces
- Sightlines from staff areas to all public areas for safety and security.
- Windows for exterior sightlines and natural daylighting.

Distribution of Space

- Accessible spaces provided in all areas of the buildings.
- Good distribution of accessible washroom and changeroom spaces to minimize travel.
- Barrier Free access to outdoors at all Multipurpose rooms

Overall Floorplan

Accessibility Review Legend

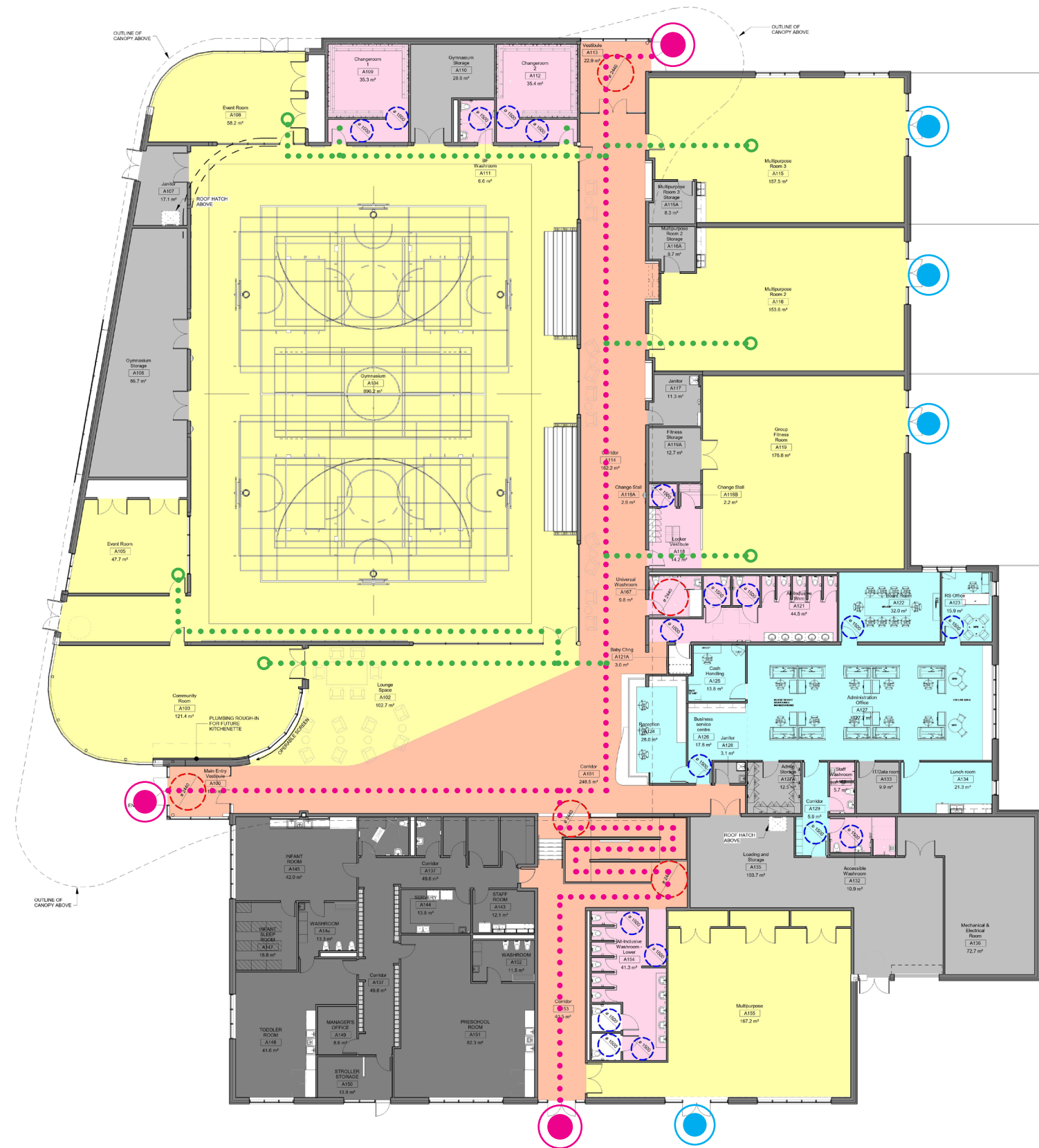

- Accessible Program Space
- Circulation Space (Accessible)
- Staff Space (Accessible)
- Storage and Service Space
- Tenant Space
- Washrooms/Changerooms
- Accessible Entry
- Access to Outdoor Program Space
- Secondary Access Route
- Primary Access Route

Reception Sightlines



North-South Corridor

Material Contrast

Material Wayfinding



Washroom and Changeroom Locations

Gymnasium Changerooms and BF Washroom

Accessibility Review Legend

- Accessible Program Space
- Circulation Space (Accessible)
- Staff Space (Accessible)
- Storage and Service Space
- Tenant Space
- Washrooms/Changerooms

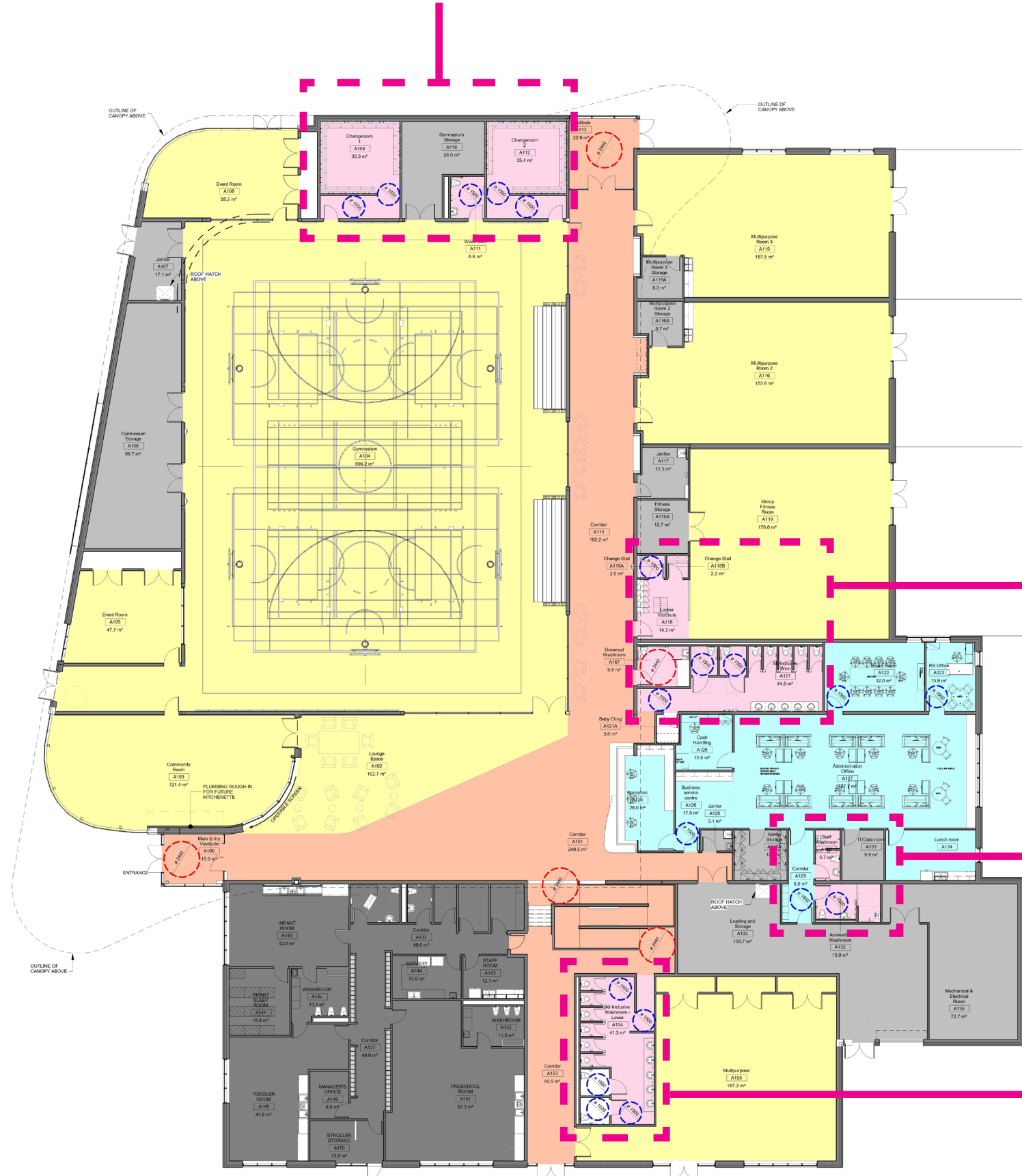

All Inclusive Washroom & Group Fitness Changerooms

Staff Washrooms

All Inclusive Washroom

Gymnasium Changerooms and Washroom

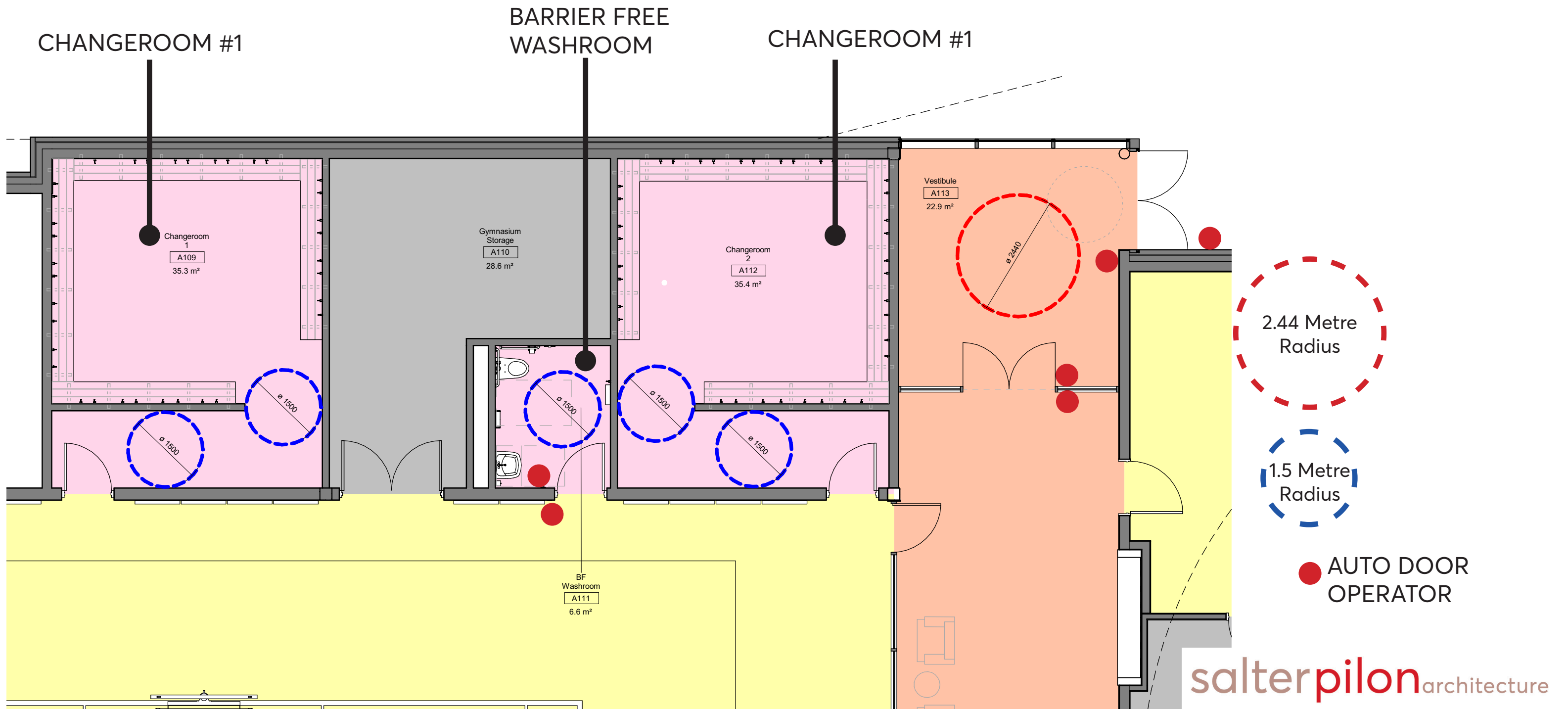

All Inclusive Washroom, Universal Washroom & Group Fitness Change Area

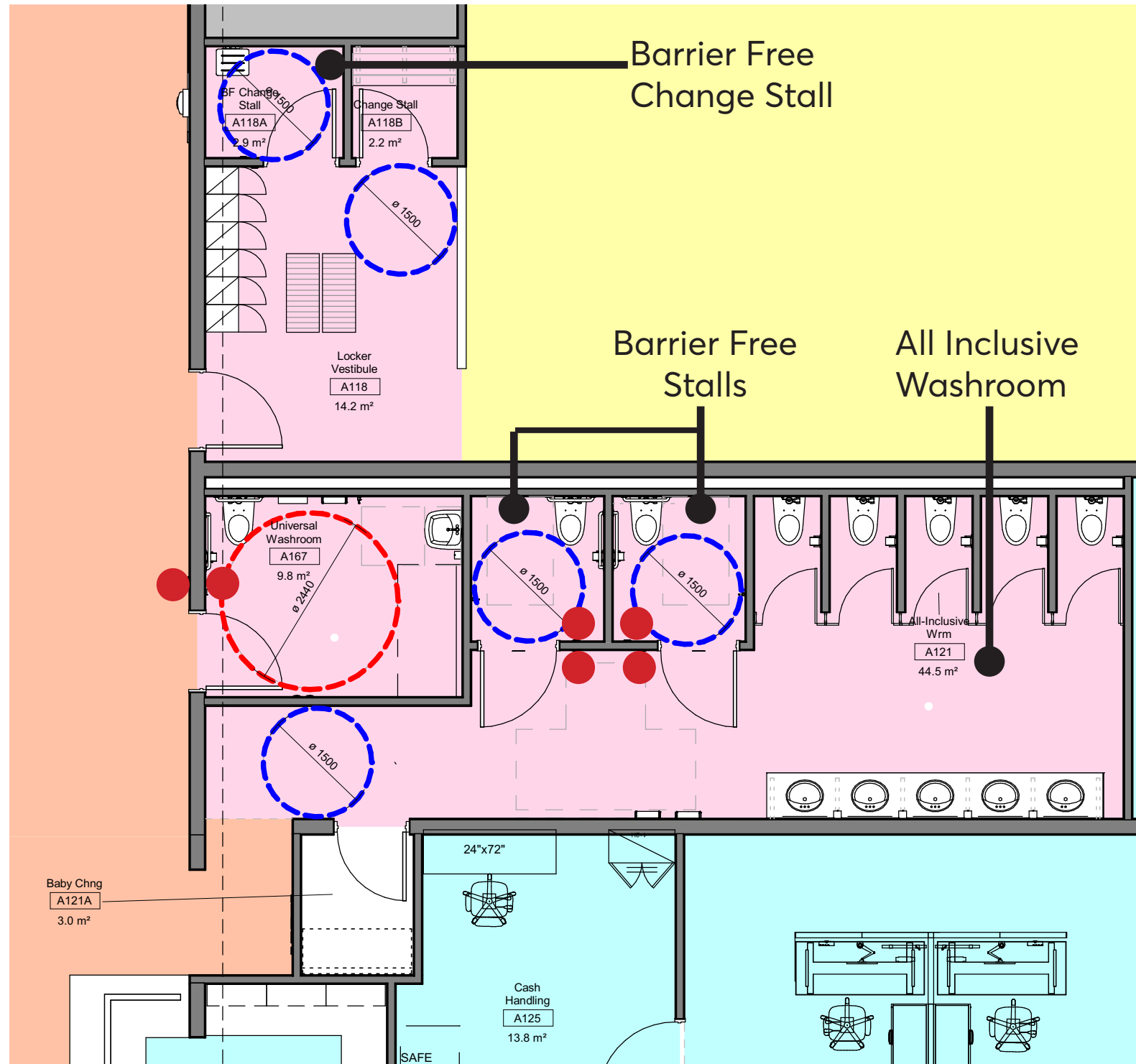

Washrooms

- All inclusive washroom facility
- 7 water closets total included (2 Barrier Free)
- 1 Universal Washroom w/ Adult Change Table
- All clearances and turnarounds from OBC and Accessibility Technical Standard adhered to and/or exceeded.
- Long entry throat length to achieve privacy.

Group Fitness

- 2 convenience change Stalls provided for group fitness. (1 Barrier Free.
- Barrier Free Access to lockers.

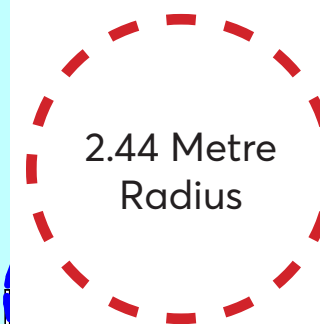

 AUTO DOOR OPERATOR

All Inclusive Washroom (Lower) & Staff Washroom Areas

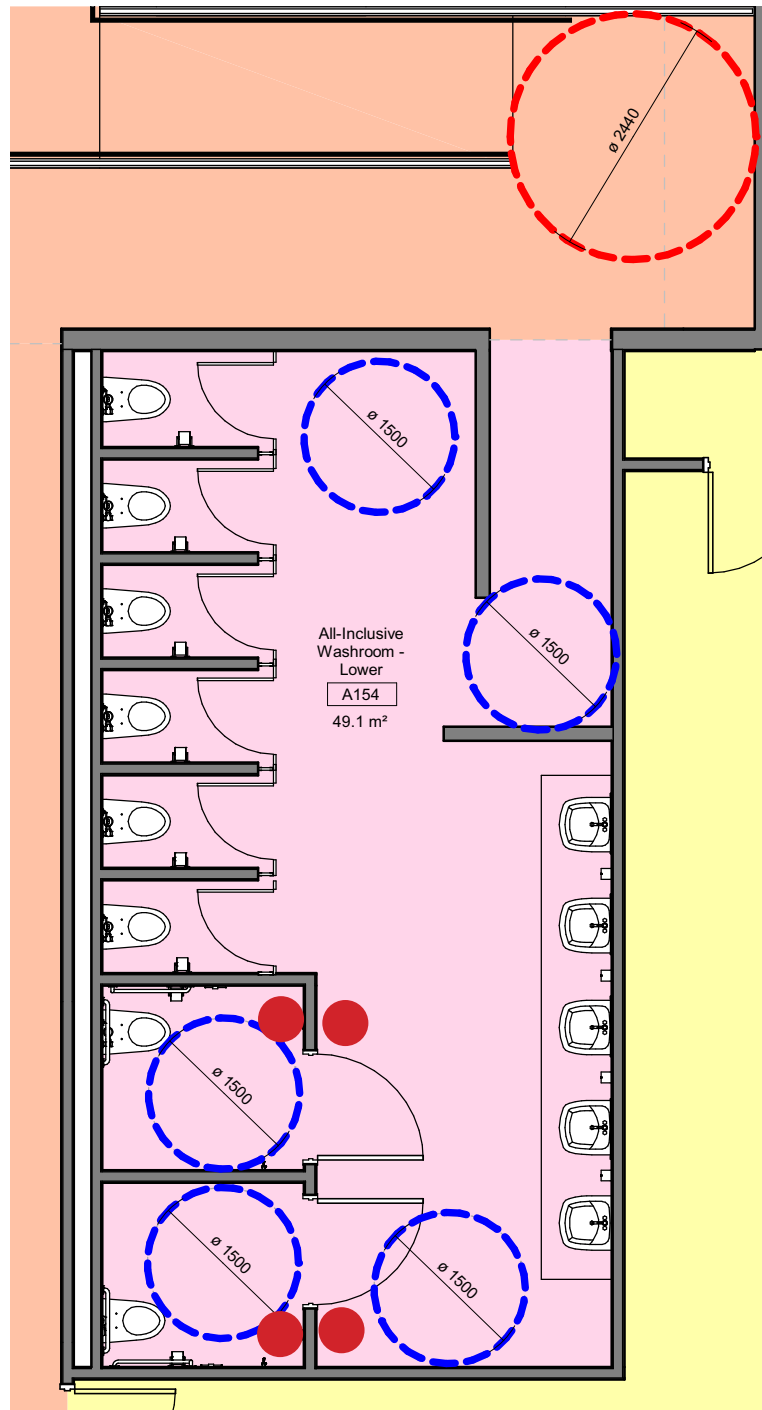

- All inclusive washroom provided at lower level of facility to provide additional capacity and support multipurpose space.
- 8 water closets total included (2 Barrier Free)
- All clearances and turnarounds from OBC and Accessibility Technical Standard adhered to.
- Long entry throat length to achieve privacy

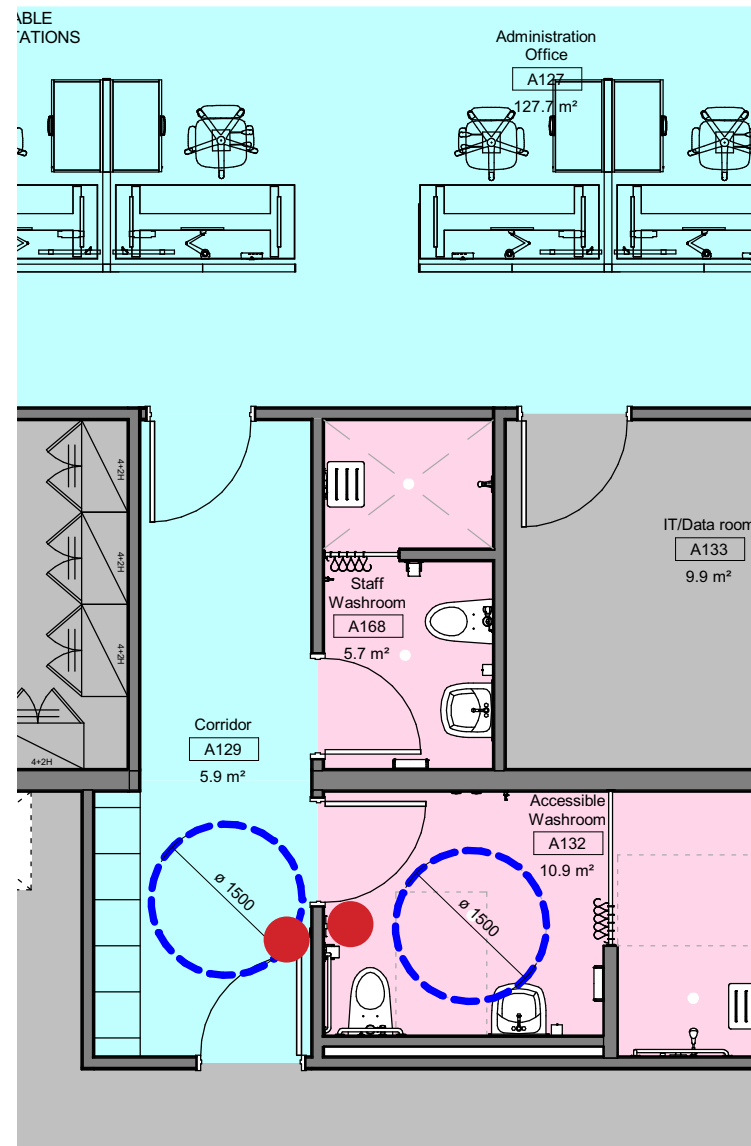

- Dedicated staff washrooms with shower space available
- 1 non accessible and one barrier free.
- Barrier free access through back of house corridor from administrative areas.

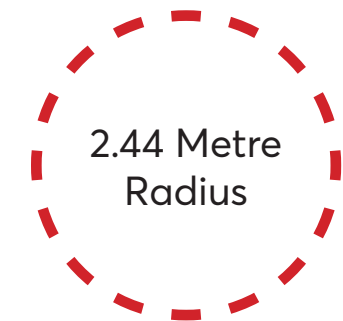

● AUTO DOOR OPERATOR

Typical All Inclusive Washroom

- Full doors on Barrier Free stalls with auto operators.
- Accessible lavatories
- High Contrast finishes particularly at fixture walls (Using coloured hygienic wall cladding)

All-Inclusive Washroom (2 locations)

- Tile flooring and base (from corridor)
- Hygienic wall cladding in colours

VIVID BLUE

PASTEL CESCO

VIVID GREEN



Solid Surface Countertop

Porcelain tile wall base 4" H

Lower Level Access

- Lower Level at rear of facility provided to give direct outdoor access to all Multi Purpose Rooms and Child Care.
- Lower Level has access to its own washroom facilities.
- Access via internal ramp or at grade at the exterior.

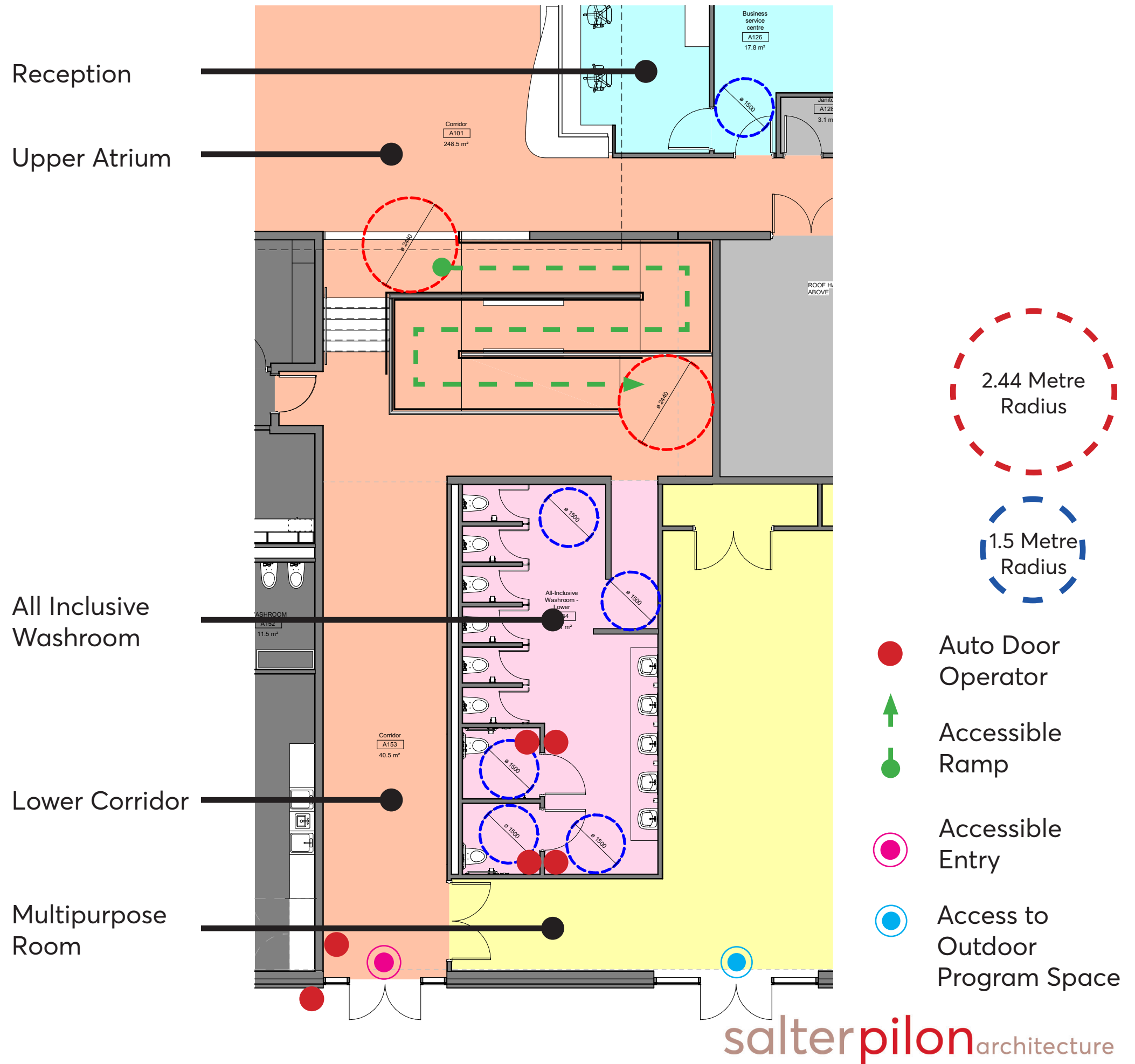

Main Reception Area



All Inclusive Washroom
in Sightline from
Reception

Reception with
accessible height
counter and clear knee
space both sides

Accessible Ramp to
Lower Level Corridor

All Inclusive Washroom
in Sightline from
Reception

Accessibility Through Staff Areas

- Staff only areas provisioned as accessible.
- All offices and space offer turnaround space in excess of the OBC and regulations
- Furniture procurement under way in conjunction with City staff all selections will be reviewed for accessibility.



Staff Area



Questions & Feedback



Please note that some exterior features and materials have changed since these renderings were produced. Updated renderings are in progress to reflect these changes and can be shared or made available at that time.