

SP45(A) – AutoCAD
Credit Valley Secondary Plan

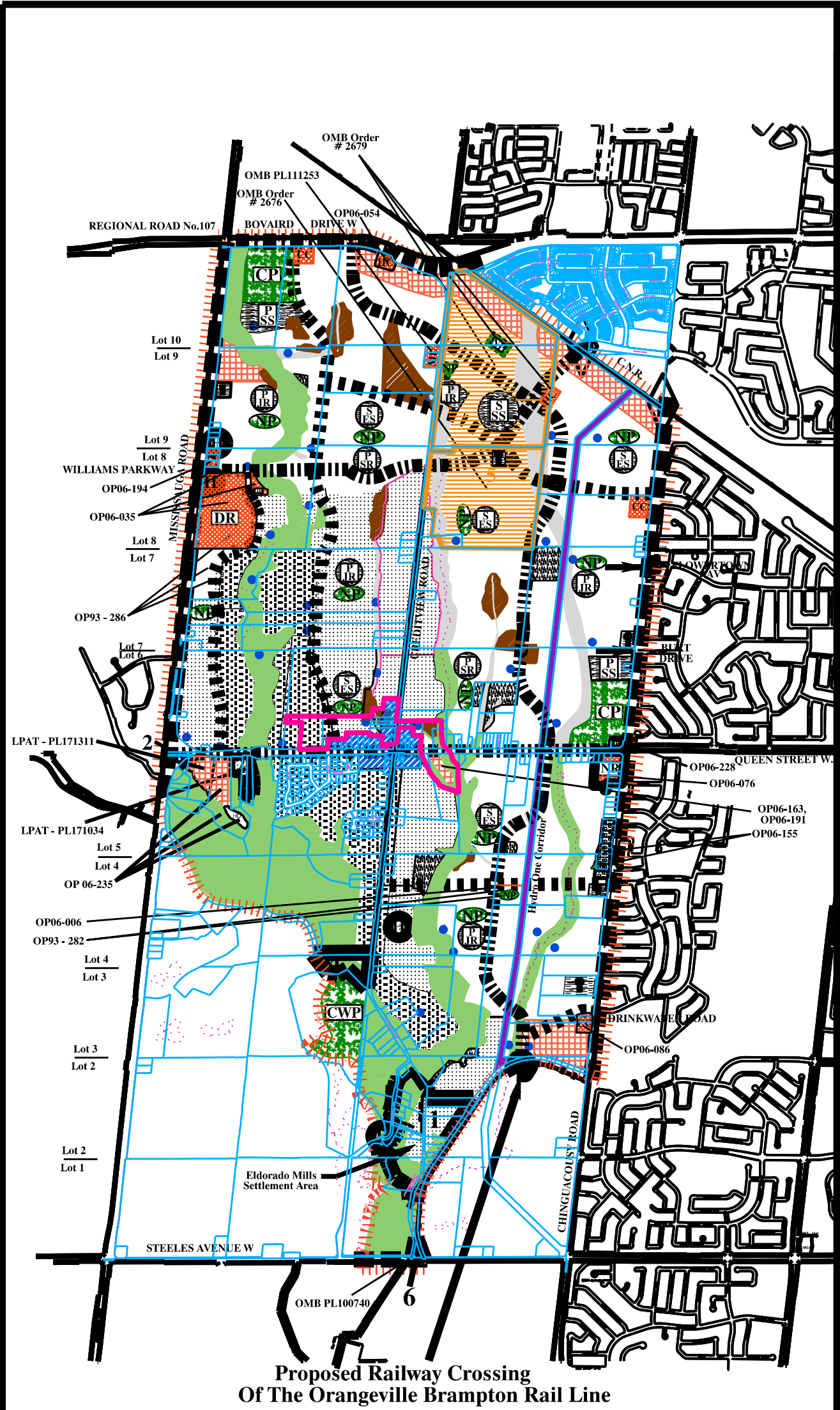
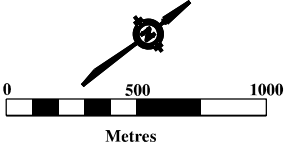

NOTE: The Heritage Resource Designations On This Schedule May Be Relocated Or Removed Without The Need For An Amendment To This Chapter.

- LAND USE DESIGNATIONS
- RESIDENTIAL
- Executive Residential
- Low Density 1
- Low Density 2
- Medium Density
- Medium Density 2
- High Density 1
- Springbrook Settlement Area
- Springbrook Tertiary Plan
- COMMERCIAL
- District Retail
- Neighbourhood Retail
- Highway Commercial
- Convenience Commercial
- Mixed Use - Commercial/High Density Residential
- INSTITUTIONAL
- Public Secondary School
- Public / Senior Elementary School
- Public / Junior Elementary School
- Separate Secondary School
- Separate Elementary School
- Place Of Worship
- Secondary Plan Boundary
- OPEN SPACE
- Primary Valleyland
- Secondary Valleyland
- Significant Woodlots
- Terrestrial Features
- City Wide Park
- Community Park
- Neighbourhood Park
- Parkette
- Potential Stormwater Management Ponds
- INFRASTRUCTURE
- Ontario Hydro Power Corridor
- Highway
- Major Arterial Roads
- Minor Arterial Roads
- Collector Roads
- Local Road Access (Potential)
- Two Lane Scenic Road
- Railways
- Heritage Resource
- Special Policy Area
- Special Policy Area 5 - Residential Low Density 2
- Grade Separation

Schedule SP 45 (a)
CREDIT VALLEY SECONDARY PLAN
Land Use Map



OFFICE CONSOLIDATION

SCHEDULE SP45(A)
CREDIT VALLEY SECONDARY PLAN



CITY OF BRAMPTON
Planning and Building Department

Date: MARCH 2023 Drawn by: CJK
Last Amendment: OP06-235
File: SP45_A_022010.dgn