

LANDS TO BE DELETED FROM "WOODLAND" DESIGNATION

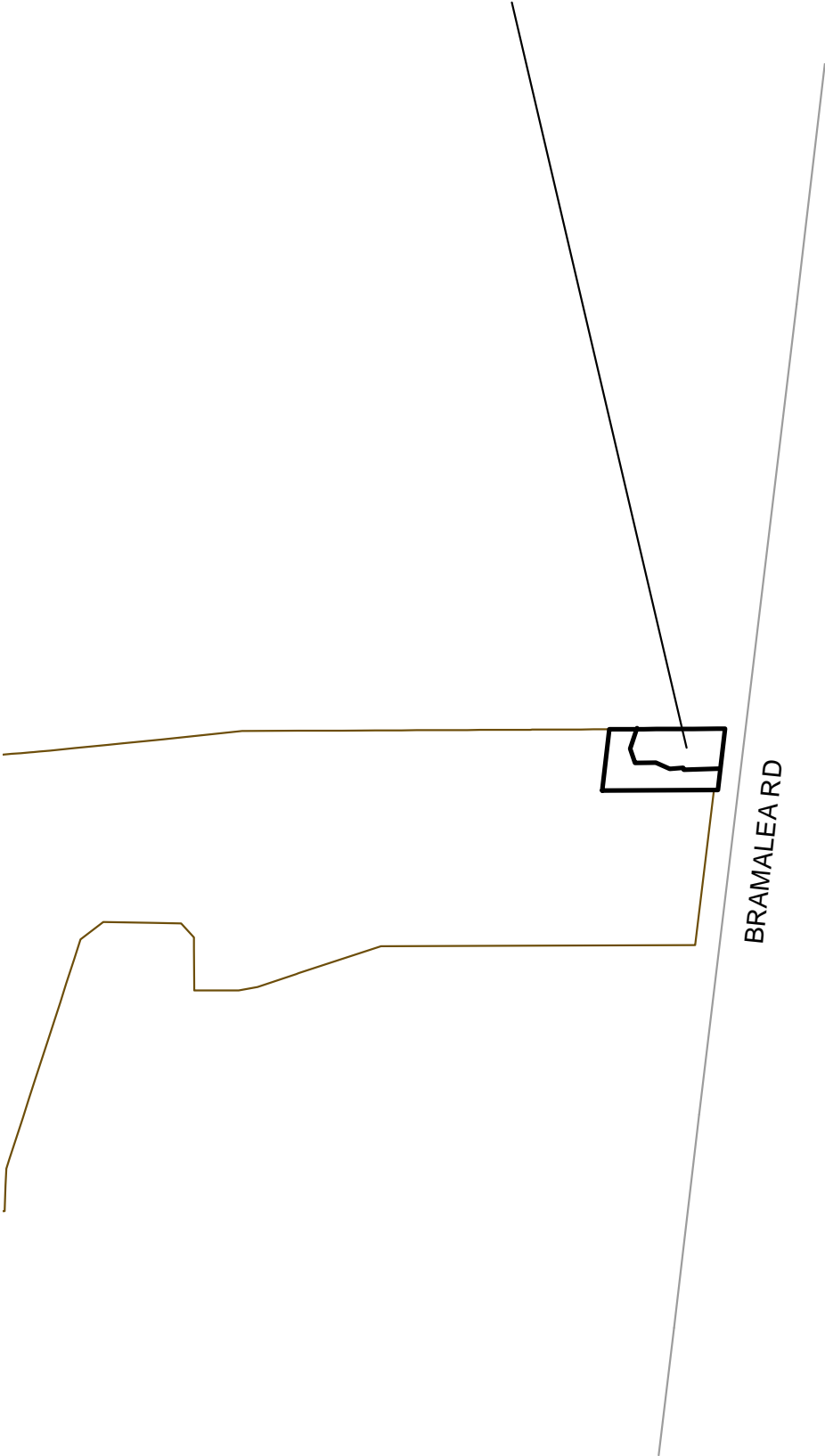

EXTRACT FROM SCHEDULE D (NATURAL HERITAGE FEATURES AND AREAS) KNOWN AS THE BRAMPTON OFFICIAL PLAN

- | | | |
|---------------------------------|----------------------------------------------------------|----------------------------------------------|
| VALLEYLAND/WATERCOURSE CORRIDOR | PROvincially SIGNIFICANT WETLAND | ENVIRONMENTALLY SENSITIVE / SIGNIFICANT AREA |
| WOODLAND | LAKES | PROVINCIAL GREENBELT/PROTECTED COUNTRYSIDE |
| SPECIAL POLICY AREA | AREAS OF NATURAL AND SCIENTIFIC INTEREST - EARTH SCIENCE | |
| OTHER WETLAND | AREAS OF NATURAL AND SCIENTIFIC INTEREST - LIFE SCIENCE | |

