



## Delegation Request

For Office Use Only:  
Meeting Name:  
Meeting Date:

Please complete this form for your request to delegate to Council or Committee on a matter where a decision of the Council may be required. Delegations at Council meetings are generally limited to agenda business published with the meeting agenda. Delegations at Committee meetings can relate to new business within the jurisdiction and authority of the City and/or Committee or agenda business published with the meeting agenda. **All delegations are limited to five (5) minutes.**

Attention: City Clerk's Office, City of Brampton, 2 Wellington Street West, Brampton ON L6Y 4R2

Email: [cityclerksoffice@brampton.ca](mailto:cityclerksoffice@brampton.ca) Telephone: (905) 874-2100 Fax: (905) 874-2119

Meeting: ☐ City Council ☐ Planning and Development Committee  
☐ Committee of Council ☐ Other Committee:

Meeting Date Requested:  Agenda Item (if applicable):

Name of Individual(s):

Position/Title:

Organization/Person being represented:

Full Address for Contact:  Telephone:   
Email:

Subject Matter to be Discussed:	<input type="text"/>
Action Requested:	<input type="text"/>

A formal presentation will accompany my delegation: ☐ Yes ☐ No

Presentation format: ☐ PowerPoint File (.ppt) ☐ Adobe File or equivalent (.pdf)  
☐ Picture File (.jpg) ☐ Video File (.avi, .mpg) ☐ Other:

Additional printed information/materials will be distributed with my delegation: ☐ Yes ☐ No ☐ Attached

**Note:** Delegates are requested to provide to the City Clerk's Office **well in advance of the meeting date:**

- (i) 25 copies of all background material and/or presentations for publication with the meeting agenda and /or distribution at the meeting, and
- (ii) the electronic file of the presentation to ensure compatibility with corporate equipment.

Once this completed form is received by the City Clerk's Office, you will be contacted to confirm your placement on the appropriate meeting agenda.

Personal information on this form is collected under authority of the Municipal Act, SO 2001, c.25 and/or the Planning Act, R.S.O. 1990, c.P.13 and will be used in the preparation of the applicable council/committee agenda and will be attached to the agenda and publicly available at the meeting and on the City's website. Questions about the collection of personal information should be directed to the Deputy City Clerk, Council and Administrative Services, 2 Wellington Street West, Brampton, Ontario, L6Y 4R2, tel. 905-874-2115.

# **PLANNING & DEVELOPMENT COMMITTEE – DECEMBER 6, 2021**

## **APPLICATION to AMEND the CITY OFFICIAL PLAN and ZONING BY-LAW**

**S. KAUR & N. KAUR  
10196 BRAMALEA ROAD**

**CITY FILE: C04E11.008  
REGION FILE: OZ-18-4E11-08B**

### **Gagnon Walker Domes Ltd.**

21 Queen Street East, Suite 500  
Brampton, Ontario  
L6W 3P1  
P (905) 796-5790

3601 Highway 7, Suite 310  
Markham, Ontario  
L3R 0M3  
P (905) 477-6556

[www.gwdplanners.com](http://www.gwdplanners.com)



# BIRDS EYE VIEW LOOKING NORTHEAST



LEGEND	
	SUBJECT SITE





## STREET VIEW and SITE PHOTOS





**SPRINGDALE FOREST**

**EXISTING RESIDENTIAL**

**2.00 m LANDSCAPE AREA (Set)**

**PRIVATE LANE**

**RESTORATION AREA**

**TRCA STAKED DRIP LINE**

**TRCA LIMIT STAKED JANUARY 5, 2017**

**15m SETBACK FROM DRILINE**

**3.00m ROAD WIDENING**

**BRAMALEA ROAD**

**SPRINGDALE FOREST**

**EXTRAPOLATED DRILINE**

**PROPOSED 3 STOREY TOWNHOMES BUILDING 'A'**

**12 UNITS & 1000 SQ. FT.**

**REAR YARD**

**FRONT YARD**

**STAIR**

**GARAGE**

**4.80m**

**5.20m**

**6.00m**

**6.20m**

**6.40m**

**6.60m**

**6.80m**

**7.00m**

**7.20m**

**7.40m**

**7.60m**

**7.80m**

**8.00m**

**8.20m**

**8.40m**

**8.60m**

**8.80m**

**9.00m**

**9.20m**

**9.40m**

**9.60m**

**9.80m**

**10.00m**

**10.20m**

**10.40m**

**10.60m**

**10.80m**

**11.00m**

**11.20m**

**11.40m**

**11.60m**

**11.80m**

**12.00m**

**12.20m**

**12.40m**

**12.60m**

**12.80m**

**13.00m**

**13.20m**

**13.40m**

**13.60m**

**13.80m**

**14.00m**

**14.20m**

**14.40m**

**14.60m**

**14.80m**

**15.00m**

**15.20m**

**15.40m**

**15.60m**

**15.80m**

**16.00m**

**16.20m**

**16.40m**

**16.60m**

**16.80m**

**17.00m**

**17.20m**

**17.40m**

**17.60m**

**17.80m**

**18.00m**

**18.20m**

**18.40m**

**18.60m**

**18.80m**

**19.00m**

**19.20m**

**19.40m**

**19.60m**

**19.80m**

**20.00m**

**20.20m**

**20.40m**

**20.60m**

**20.80m**

**21.00m**

**21.20m**

**21.40m**

**21.60m**

**21.80m**

**22.00m**

**22.20m**

**22.40m**

**22.60m**

**22.80m**

**23.00m**

**23.20m**

**23.40m**

**23.60m**

**23.80m**

**24.00m**

**24.20m**

**24.40m**

**24.60m**

**24.80m**

**25.00m**

**25.20m**

**25.40m**

**25.60m**

**25.80m**

**26.00m**

**26.20m**

**26.40m**

**26.60m**

**26.80m**

**27.00m**

**27.20m**

**27.40m**

**27.60m**

**27.80m**

**28.00m**

**28.20m**

**28.40m**

**28.60m**

**28.80m**

**29.00m**

**29.20m**

**29.40m**

**29.60m**

**29.80m**

**30.00m**

**30.20m**

**30.40m**

**30.60m**

**30.80m**

**31.00m**

**31.20m**

**31.40m**

**31.60m**

**31.80m**

**32.00m**

**32.20m**

**32.40m**

**32.60m**

**32.80m**

**33.00m**

**33.20m**

**33.40m**

**33.60m**

**33.80m**

**34.00m**

**34.20m**

**34.40m**

**34.60m**

**34.80m**

**35.00m**

**35.20m**

**35.40m**

**35.60m**

**35.80m**

**36.00m**

**36.20m**

**36.40m**

**36.60m**

**36.80m**

**37.00m**

**37.20m**

**37.40m**

**37.60m**

**37.80m**

**38.00m**

**38.20m**

**38.40m**

**38.60m**

**38.80m**

**39.00m**

**39.20m**

**39.40m**

**39.60m**

**39.80m**

**40.00m**

**40.20m**

**40.40m**

**40.60m**

**40.80m**

**41.00m**

**41.20m**

**41.40m**

**41.60m**

**41.80m**

**42.00m**

**42.20m**

**42.40m**

**42.60m**

**42.80m**

**43.00m**

**43.20m**

**43.40m**

**43.60m**

**43.80m**

**44.00m**

**44.20m**

**44.40m**

**44.60m**

**44.80m**

**45.00m**

**45.20m**

**45.40m**

**45.60m**

**45.80m**

**46.00m**

**46.20m**

**46.40m**

**46.60m**

**46.80m**

**47.00m**

**47.20m**

**47.40m**

**47.60m**

**47.80m**

**48.00m**

**48.20m**

**48.40m**

**48.60m**

**48.80m**

**49.00m**

**49.20m**

**49.40m**

**49.60m**

**49.80m**

**50.00m**

**50.20m**

**50.40m**

**50.60m**

**50.80m**

**51.00m**

**51.20m**

**51.40m**

# LANDSCAPE & RESTORATION PLANTING PLAN

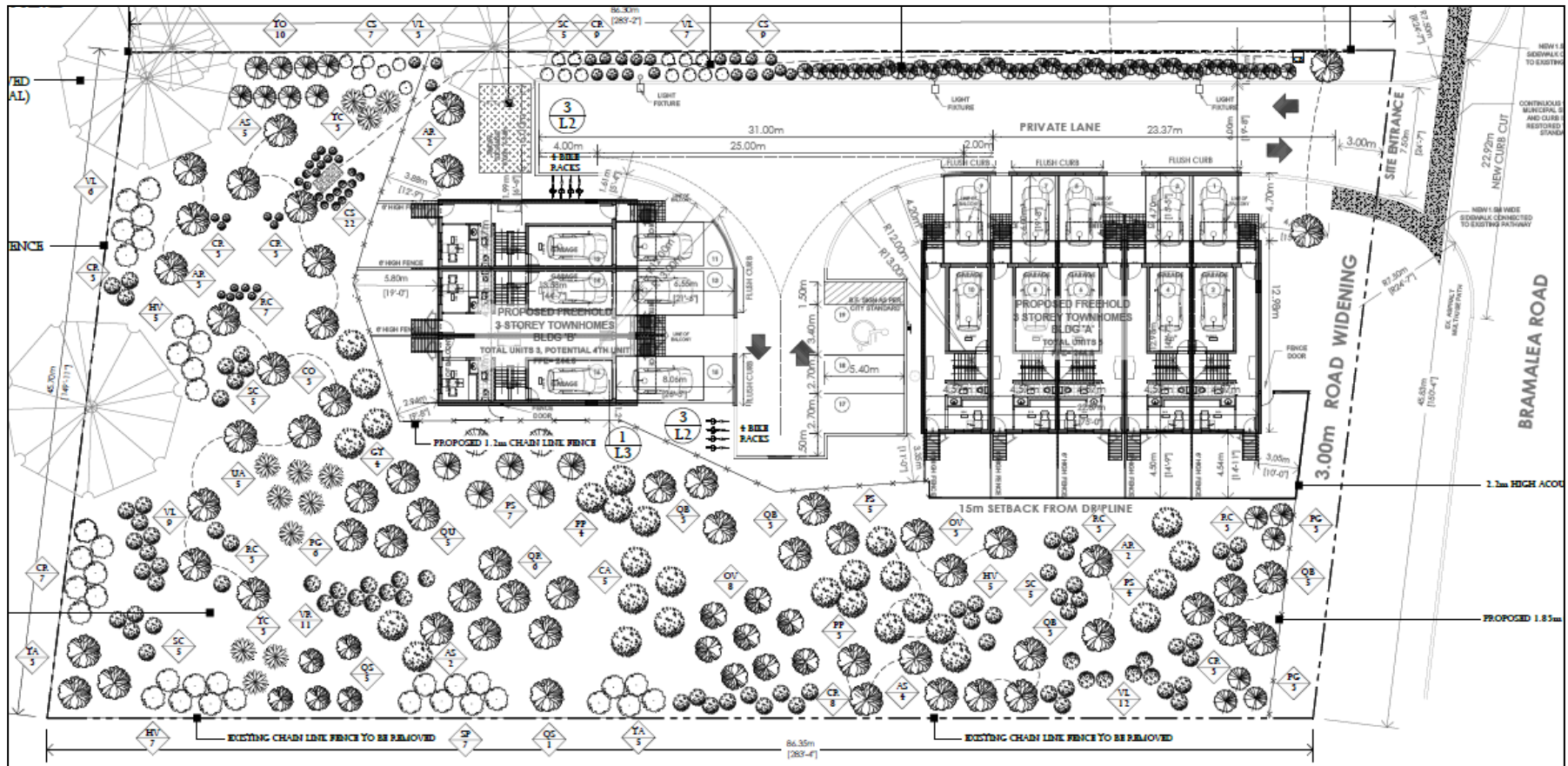

- ✓ Proposal includes a 15.0 metre wide buffer. Tree planting and restoration works will mitigate previous tree removals and enhance the City owned woodlot. The buffer is to be dedicated to the City at a future date.



## **TIMELINE of PLANNING PROCESS**

- March 2016 – Pre-Application Consultation.
- January 2017 – Dripline staking with City, Region, and TRCA.
- June 2016 – Submission of Formal Amendment Application.
- February 2019 – Amendment Application deemed “Complete”.
- April 2019 – Statutory Public Meeting.
- May 2019 – November 2021 – Liaising with City Staff, agencies, Members of Council, addressing circulation comments and/or issues.
- December 2021 – Tabling of the Recommendation Report at Planning and Development Committee.





## SECTION 36 of PLANNING ACT

- The Planning Act, through Section 36, allows the Council of a municipality to specify the use of lands with a holding symbol “H” until certain conditions are met, and at such time in the future, the holding symbol is removed and the lands can avail of various new uses and regulations.
- The Holding (H) Zone establishes the proposed land uses but does not allow for the development to proceed until such time as the conditions associated with the proposal are fulfilled to the satisfaction of the various departments at the City of Brampton.
- Holding (H) Zone is a common tool that is being utilized across the City on a site specific basis.





## PLANNING & DEVELOPMENT COMMITTEE REQUEST

- ✓ Receive Staff Recommendation Report and Delegation.
- ✓ Approve the Official Plan Amendment.
- ✓ Approve the Zoning By-law Amendment inclusive of Holding (H) provisions requiring the finalization of the following studies:
  - A Functional Servicing Report;
  - Urban Design Brief;
  - Sustainability Score and Summary;
  - Restoration Planting Plan;
  - Environmental Impact Study;
  - Arborist Report;
  - Arrangements to convey the 15.0 metre buffer.