

LANDS TO BE REDESIGNATED FROM "ESTATE RESIDENTIAL" TO
 "MEDIUM-HIGH DENSITY RESIDENTIAL" AND "SPECIAL POLICY AREA 5"

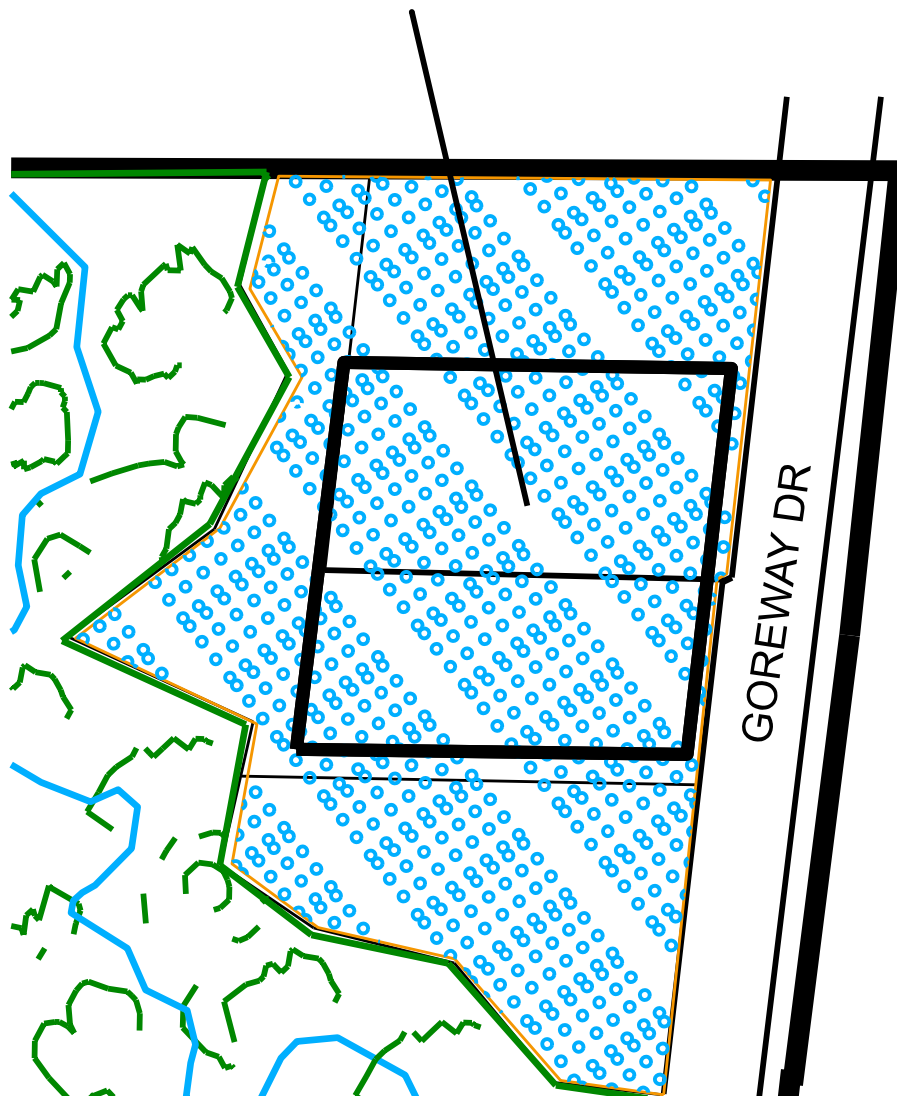

EXTRACT FROM SCHEDULE SP39(A) OF THE DOCUMENT KNOWN AS THE GOREWAY DRIVE CORRIDOR SECONDARY PLAN

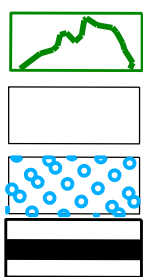

OPEN SPACE
RESIDENTIAL
ESTATE RESIDENTIAL
BOUNDARY OF SUBJECT LANDS

