

This drawing, as an instrument of service, is provided by and is the property of Graziani + Corazza Architects Inc. The contractor must verify and accept responsibility for all dimensions and conditions on site and must notify Graziani + Corazza Architects Inc. of any variations from the supplied information. Graziani + Corazza Architects Inc. is not responsible for the accuracy of survey, structural, mechanical, electrical, etc., engineering information shown on this drawing. Refer to the appropriate engineering drawings before proceeding with the work. Construction must conform to all applicable codes and requirements of the authorities having jurisdiction. Unless otherwise noted, no investigation has been undertaken or reported on by this office in regards to the environmental condition of this site.

This drawing is not to be scaled. All architectural symbols indicated on this drawing are graphic representations only.

Conditions for electronic information transfer

Electronic information is supplied to the other associated firms to assist them in the execution of their work/view. The recipient firms must determine the completeness/appropriateness/relevance of the information in respect to their particular responsibility.

Graziani + Corazza Architects Inc. shall not be responsible for:

- Errors, omissions, incompleteness due to loss of information in whole or part when information is transferred.
- Transmission of any virus or damage to the receiving electronic system when information is transferred.

01. Feb. 11, 2022 Issued to City of Brampton 96

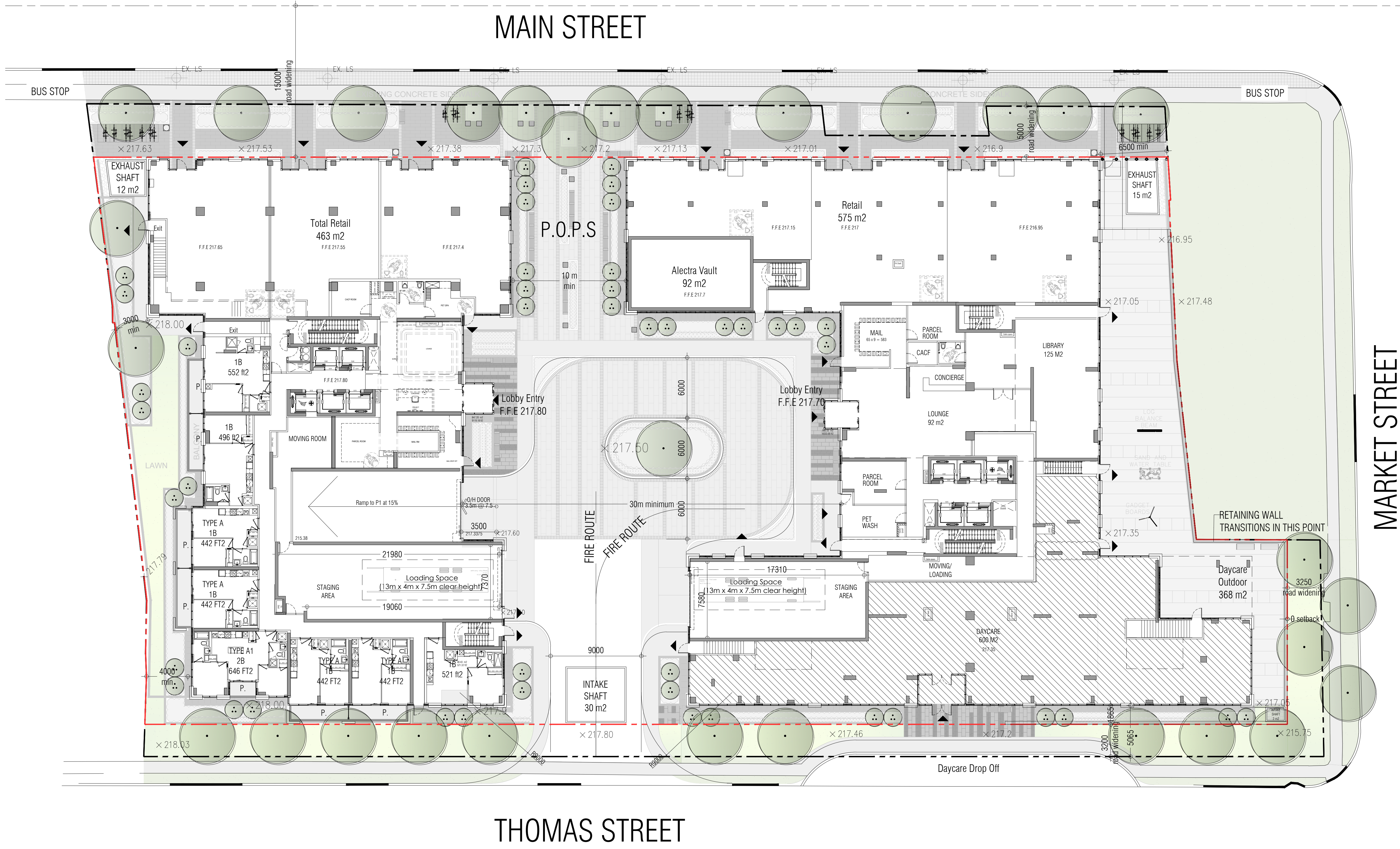

MARKET STREET

issued for revisions

GRAZIANI + CORAZZA ARCHITECTS INC.

B. BERARDO E. GRAZIANI
LICENCE 4684

1320 Shawson Drive, Suite 100, Mississauga, Ontario L4W 1C3
Phone: 905.795.2601 Fax: 905.795.2844 www.gc-architects.com

Residential Development

MAIN AND MARKET

199 Main Street
Brampton Ontario

Project Architect: **B. Graziani**
Assistant Designer: **R. Alani/M. Albaghdadi**
Drawn By: **R. Alani/M. Albaghdadi**
Checked By: **G. Colangelo/D. Biase**
Plot Date: **Feb. 11, 2022**
Job #: **1914.21**

GROUND FLOOR

1:200 **A301**