

# SAVE HUTTONVILLE FORREST

ECOLOGICAL AND HUMAN CONSEQUENCES



# GLOBAL AND LOCAL ECOLOGICAL CRISIS

- AND WE ONLY PAY LIP SERVICE
- CREATE FALSE SOLUTION THAT GAME THE SYSTEM ....
- PROFITS SEEM TO TRUMP EVERYTHING



from Greenspace to homes  
 ..a \$50 Million developer  
 give-away?

Huttonville Forest  
 was to be preserved

2006 BramWest Master plan - forest as Greenspace



2022 - forest as 37 executive building lots

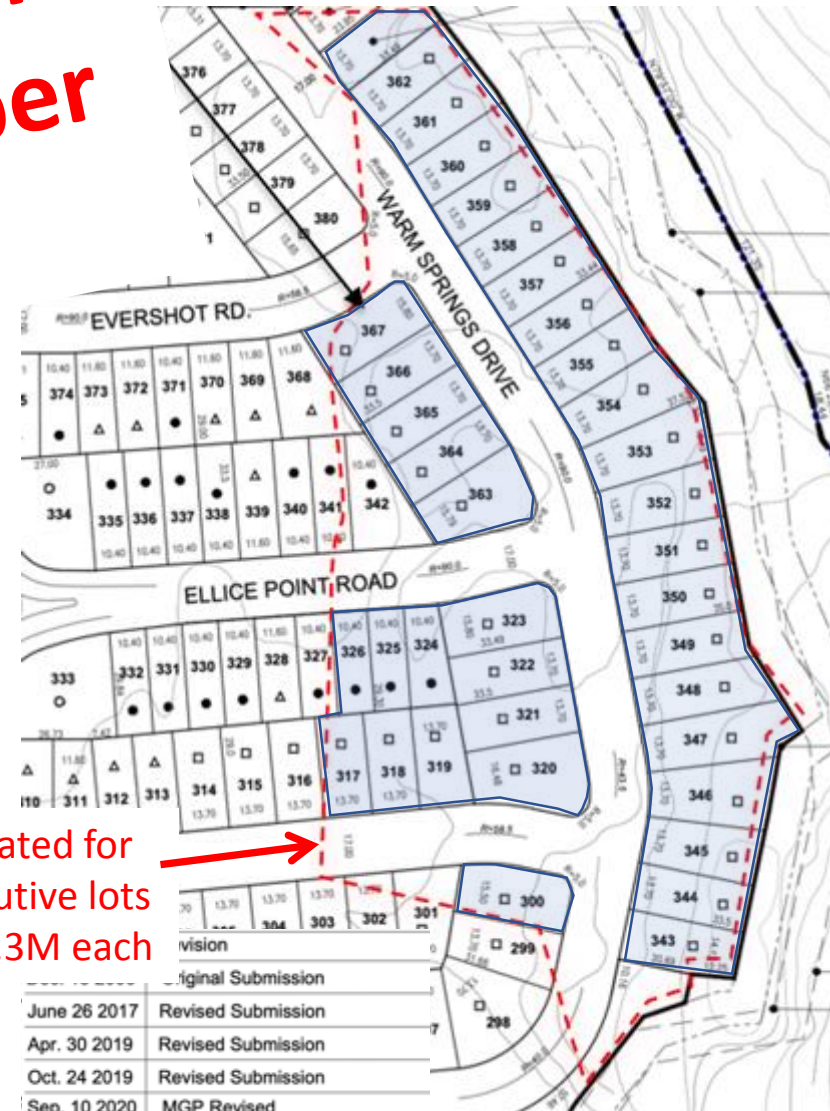

Now slated for  
 37 executive lots  
 aver. \$1.3M each

# MASSIVE HOMES = MASSIVE IMPACT

- LESS HOUSING PER LAND
  - CLIMATE CHANGE
  - LAND USE CHANGE
  - BIODIVERSITY LOSS
- 
- But luxury is big money for a few people ...

# CLIMATE CHANGE

- MASSIVE CARBON RELEASE FROM DEFORESTATION
- THIS FOREST ALONE, AS IT GROWS, WILL STORE THOUSANDS OF TONES CARBON PER YEAR

# LOCAL BIODIVERSITY AND ECOSYSTEM LOSS

- ENDANGERED SPECIES
- NON ENDANGERED SPECIES ALSO HAVE VALUE
- TREES
- AMPHIBIANS – TURTLES / FROGS
- MAMMALS – DEER
- BIRDS – EAGLES
- FOREST AND WETLAND AT STAKE

# REGIONAL BIODIVERSITY LOSS - CONNECTIVITY

- WE ARE CUTTING OFF A WILDLIFE CORRIDOR!!!!!!
- DEER AND OTHER SPECIES NEED A **WIDE SWATH OF INTACT FOREST** TO MOVE UP AND DOWN THE ENTIRE CREDIT VALLEY RIVER SYSTEM FROM LAKE TO MOST UPSREAM CREDIT RIVER
- **ANYTHING CUTTING SO CLOSE WILL IMPACT THE ENTIRE CREDIT VALLEY RIVER ECO SYSTEM**
  - ZERO MENTION OF THIS IN ECOLOGICAL ASSESSMENT MADE BY DEVELOPER

# ECO REPORTS WITH CONFLICT OF INTEREST

- BY DEVELOPER AND THOSE LINKED TO THEM IN THE CITY
- PEOPLE TAKING PATH OF LEAST RESISTANCE
- MASSIVE CONFLICT OF INTEREST



# ECO REPORT FROM DEVELOPER HAS SERIOUS PROBLEMS - BIAS / CONFLICT OF INTEREST

- MINIMIZE ECOLOGICAL VALUE
- REGENERATING FORESTS ARE CRITICAL
- NON-NATIVE TREES ARE STILL TREES
- DO NOT RECOGNIZE RARE TREE SPECIES THAT ARE NATIVE
- OVEREMPHASIZE SOME DEBRIS LEFT OVER
- “MITIGATION” IS A DANGEROUS/FALSE ECO CONCEPT
  - INHERENTLY MEANS THAT WE ARE DOING SOMETHING DESTRUCTIVE
  - YOU CAN'T DESTROY A FOREST AND SAY WE WILL PLANT TREES ELSEWHERE
  - ETC ....

# WE WILL LOSE OPPORTUNITY FOR A TRAIL

- THIS COULD BE AN AMAZING AND BEAUTIFUL TRAIL
  - LAKE ONTARIO TO THE NORTH MOST OF CREDIT VALLEY
- RESPECT INDIGINOUS HERITAGE
- HUGE ACCESS TO NATURE FROM BRAMPTON PUBLIC
  - HEALTH EFFECTS
  - MOST OF OUR DEMOGRAPHIC DO NOT HAVE GOOOD ACCESS TO NATURE

# WHEN YOU DEVELOP IT = GONE FOREVER

- 75% OF THE EARTH'S SURFACE HAS BEEN HUMAN ALTERED / FRAGMENTED
- IN CANADA – MOST BIODIVERSE AREAS ARE BEING DEVELOPED
- WE HAVE DESTROYED 99% OF SOUTHERN ONTARIO ECO SYSTEMS
  - THESE AREAS ARE ALL THAT IS LEFT
  - AND WE CONTINUE TO DEVELOP THEM RATHER THAN PROTECT AND REFOREST

# ALTERNATIVE IS POSSIBLE

- INCREASE SOME DENSITY ON THE FARMLAND THAT IS BEING DEVELOPED
- HOUSE THE SAME OR MORE PEOPLE
- DEVELOPER CAN MAKE THEIR PROFIT
- SAVE THE FOREST
- MAKE A TRAIL



# BEAUTY GONE FOREVER

