

SAVE HUTTONVILLE FORREST

ECOLOGICAL AND HUMAN CONSEQUENCES



GLOBAL AND LOCAL ECOLOGICAL CRISIS

- AND WE ONLY PAY LIP SERVICE
- CREATE FALSE SOLUTION THAT GAME THE SYSTEM
- PROFITS SEEM TO TRUMP EVERYTHING

**from Greenspace to homes
..a \$50 Million developer
give-away?**

2022 - forest as 37 executive building lots

Huttonville Forest
was to be preserved

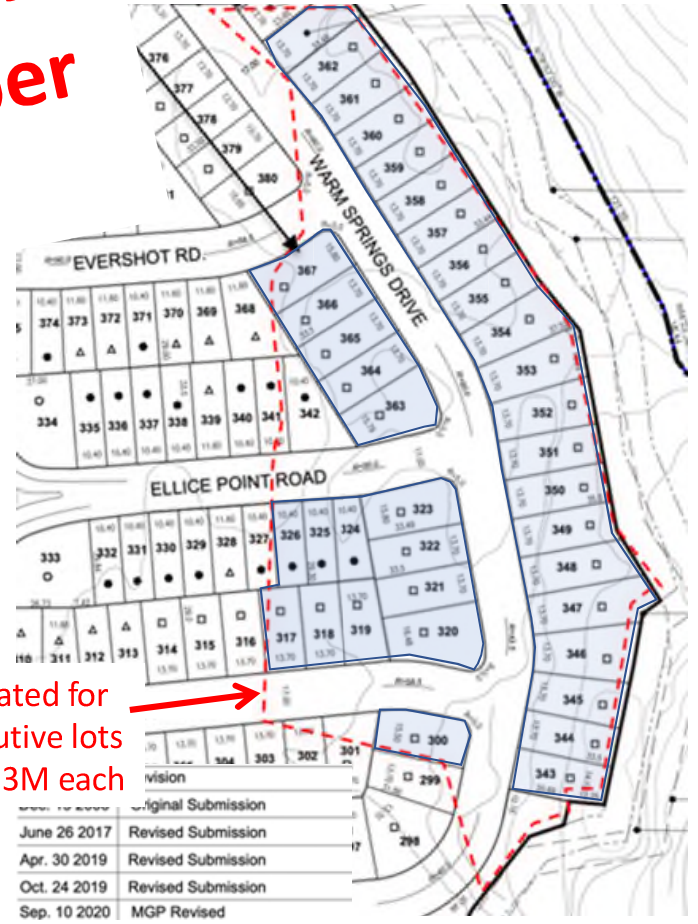
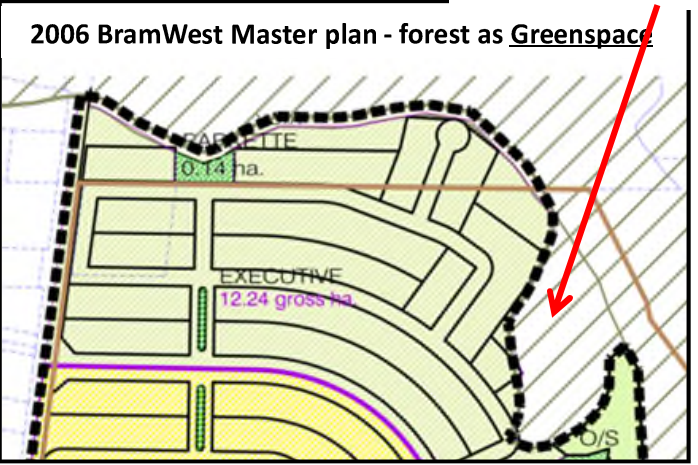

MASSIVE HOMES = MASSIVE IMPACT

- LESS HOUSING PER LAND
 - CLIMATE CHANGE
 - LAND USE CHANGE
 - BIODIVERSITY LOSS
-
- But luxury is big money for a few people ...

CLIMATE CHANGE

- MASSIVE CARBON RELEASE FROM DEFORESTATION
- THIS FOREST ALONE, AS IT GROWS, WILL STORE THOUSANDS OF TONES CARBON PER YEAR

LOCAL BIODIVERSITY AND ECOSYSTEM LOSS

- ENDANGERED SPECIES
- NON ENDANGERED SPECIES ALSO HAVE VALUE
- TREES
- AMPHIBIANS – TURTLES / FROGS
- MAMMALS – DEER
- BIRDS – EAGLES

- FOREST AND WETLAND AT STAKE

REGIONAL BIODIVERSITY LOSS - CONNECTIVITY

- WE ARE CUTTING OFF A WILDLIFE CORRIDOR!!!!
- DEER AND OTHER SPECIES NEED A **WIDE SWATH OF INTACT FOREST** TO MOVE UP AND DOWN THE ENTIRE CREDIT VALLEY RIVER SYSTEM FROM LAKE TO MOST UPSREAM CREDIT RIVER
- **ANYTHING CUTTING SO CLOSE WILL IMPACT THE ENTIRE CREDIT VALLEY RIVER ECO SYSTEM**
 - ZERO MENTION OF THIS IN ECOLOGICAL ASSESSMENT MADE BY DEVELOPER

ECO REPORTS WITH CONFLICT OF INTEREST

- BY DEVELOPER AND THOSE LINKED TO THEM IN THE CITY
- PEOPLE TAKING PATH OF LEAST RESISTANCE

- MASSIVE CONFLICT OF INTEREST

ECO REPORT FROM DEVELOPER HAS SERIOUS PROBLEMS - BIAS / CONFLICT OF INTEREST

- MINIMIZE ECOLOGICAL VALUE
- **REGENERATING FORESTS ARE CRITICAL**
- NON-NATIVE TREES ARE STILL TREES
- DO NOT RECOGNIZE RARE TREE SPECIES THAT ARE NATIVE
- OVEREMPHASIZE SOME DEBRIS LEFT OVER
- **“MITIGATION” IS A DANGEROUS/FALSE ECO CONCEPT**
 - INHERENTLY MEANS THAT WE ARE DOING SOMETHING DESTRUCTIVE
 - YOU CAN'T DESTROY A FOREST AND SAY WE WILL PLANT TREES ELSEWHERE
 - ETC

WE WILL LOSE OPPORTUNITY FOR A TRAIL

- THIS COULD BE AN AMAZING AND BEAUTIFUL TRAIL
 - LAKE ONTARIO TO THE NORTH MOST OF CREDIT VALLEY
- RESPECT INDIGINOUS HERITAGE
- HUGE ACCESS TO NATURE FROM BRAMPTON PUBLIC
 - HEALTH EFFECTS
 - MOST OF OUR DEMOGRAPHIC DO NOT HAVE GOOD ACCESS TO NATURE

WHEN YOU DEVELOP IT = GONE FOREVER

- 75% OF THE EARTH'S SURFACE HAS BEEN HUMAN ALTERED / FRAGMENTED
- IN CANADA – MOST BIODIVERSE AREAS ARE BEING DEVELOPED
- WE HAVE DESTROYED 99% OF SOUTHERN ONTARIO ECO SYSTEMS
 - THESE AREAS ARE ALL THAT IS LEFT
 - AND WE CONTINUE TO DEVELOP THEM RATHER THAN PROTECT AND REFOREST

ALTERNATIVE IS POSSIBLE

- INCREASE SOME DENSITY ON THE FARMLAND THAT IS BEING DEVELOPED
- HOUSE THE SAME OR MORE PEOPLE
- DEVELOPER CAN MAKE THEIR PROFIT
- SAVE THE FOREST
- MAKE A TRAIL

BEAUTY GONE FOREVER

