

City Hall Parking Garage Rehabilitation and Elevator Replacement



** Alternate formats available upon request, please email accessibility@Brampton.ca

Description:

- Located at 2 Wellington Street West, Brampton, Ontario
- Four Level underground Parking Structure- directly below City Hall
- Constructed in 1988
- Suspended slabs on P1, P2, P3 and slab on grade for P4 and part of P3 – Public parking capacity - 349
- Garage entrance and Loading Dock accessed from George Street South



Scope of Work:

- Replace waterproofing membrane above the garage roof slab.
- Replace the asphalt in front of Loading Dock and Snow Melting system for the ramp.
- Full replacement of the waterproofing/traffic topping system with a new thin elastomeric waterproofing for Parking Garage slab.
- Localized repairs to delaminated/deteriorated concrete for columns and walls.
- Remove corrosion from existing railings in Stairwell E and repaint.
- Replace corroded railings within Stairwell F.
- Refurbishment of the existing underground parking elevators.

Major Timeline:

- Contractor mobilization: **27th Feb, 2023**
- Phase 1 and Phase 2 Completion: **11th June, 2023**
- City Hall Garage complete closure: **Mid June-Mid Aug**
- Project Substantial Completion: **23rd Aug, 2023**

Effect on Accessibility Parking:

Phase 1 and Phase 2: **None**

Complete Closure: **8 Accessible Parking Spots will be lost**

Remediation:

- 2 additional accessible parking will be provided at West Tower (12 accessible spots). Parking will monitor the parking situation everyday and in case of shortage additional accessible parking will be provided
- Staff of City Clerks and Service Brampton will each relocate 2 workstations to West Tower to service residents with accessibility needs
- 3rd floor meeting rooms at West Tower will be available for other departments to reserve as needed

WorkStation layout at West Tower:

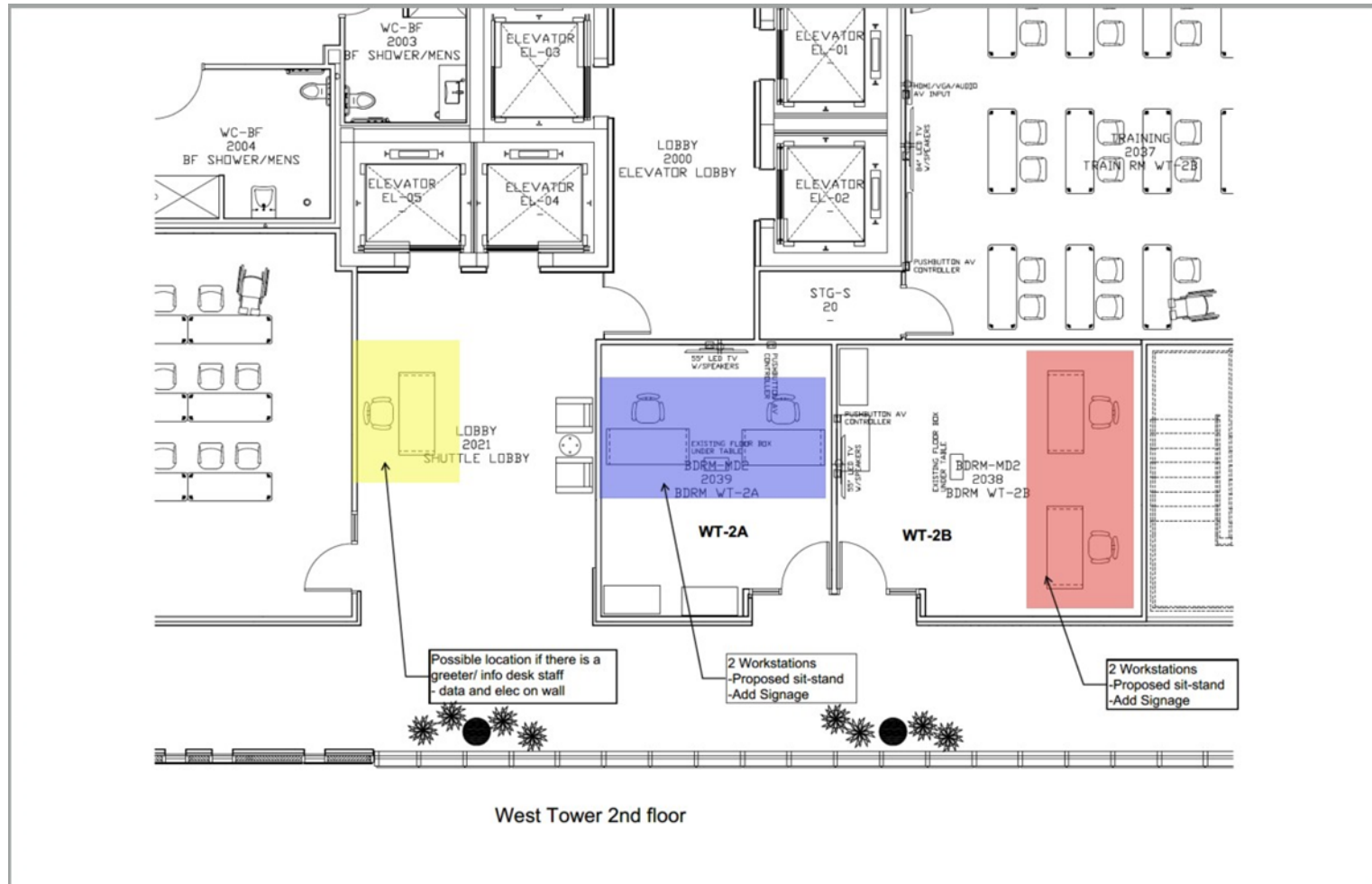

Signage and Wayfinding:

- Information desk at 2nd floor elevator lobby
- Signage in parking vestibules and elevators
 - “Access to City Hall – Floor 2”
- Floor Decals/Floor Standing Signs to the two rooms for accessibility requirements
- Signage at Entrance of both room
 - “Service Brampton”
 - “Clerks”



Questions/Comments