

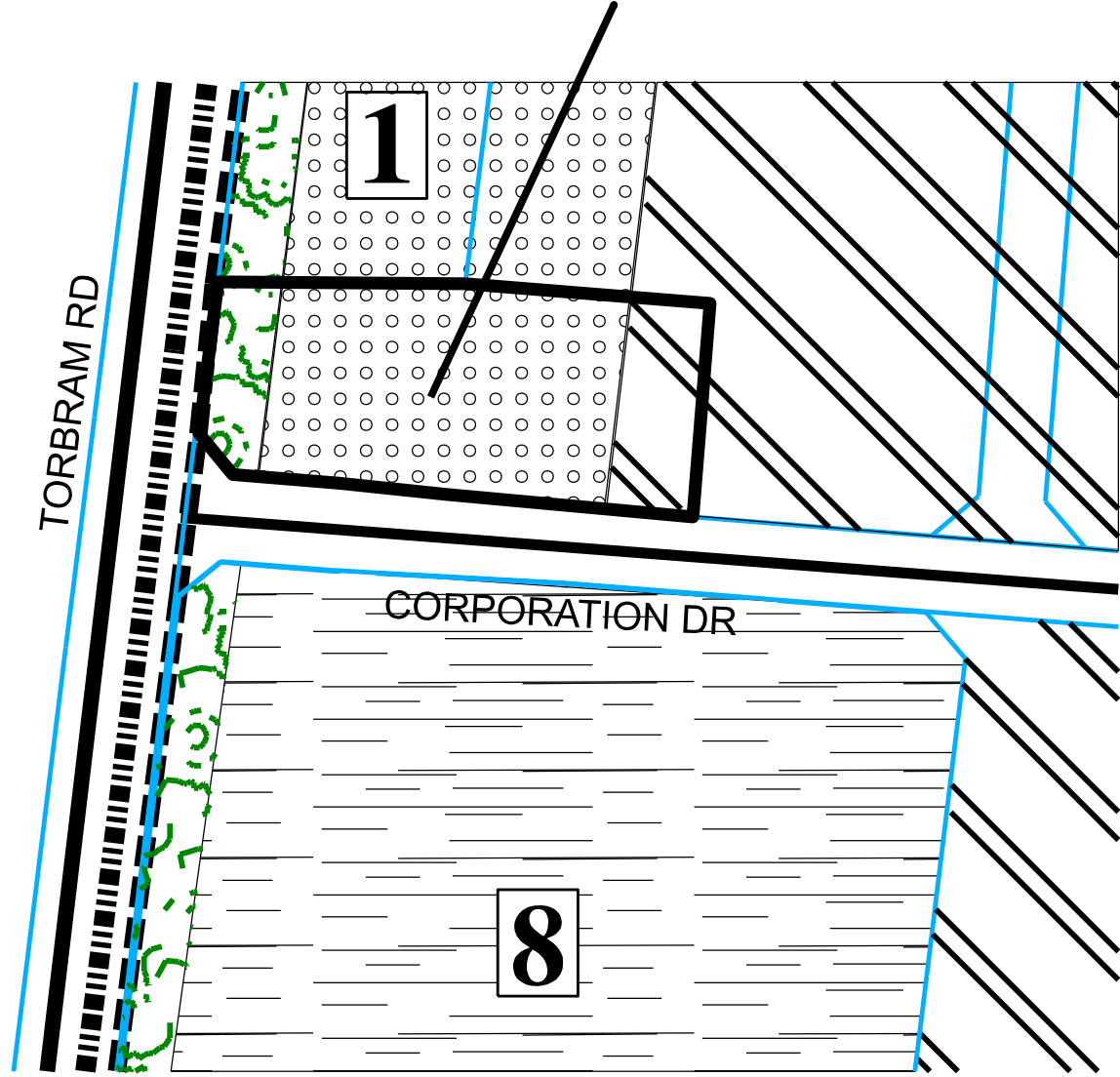





SUBJECT LANDS

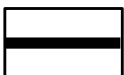

EXTRACT FROM SCHEDULE SP13(A) OF THE DOCUMENT KNOWN AS THE BRAMALEA SOUTH INDUSTRIAL SECONDARY PLAN

	Lands Subject To This Amendment		Collector roads
	Open Space		Area Affected By This Amendment
	General Industrial		Special Policy Area 1 (Refer To Policy 3.4.1)
	Prestige Industrial		Special Policy Area 8 (Refer To Policy 3.4.8)
	Institutional		

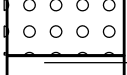
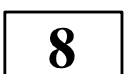
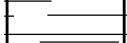